



City of NAPOLEON, OHIO

255 RIVERVIEW AVENUE — (419) 592-4010

September 9, 1980

Mr. Randy Kelly
1018 Dodd St.
Napoleon, OH 43545

Mayor
Robert G. Heft

Re: Building Permit

Clerk-Treasurer
Rupert W. Schweinhagen

Dear Sir:

Members of Council
Lawrence Haase, President
James Jackson
William Young
Darel Austermillier
Darrell Fox
James Zumfelde

Your request to erect a building 12 X 16 on the end of Hogrefe Auto Parts & Junkyard has been denied. The reason for the denial is that the junkyard and residential building that is on this property are a non-conforming use in a "PB" Planned Business District.

City Manager
Alan E. Tandy

Section 151.31 of the Napoleon Zoning Code under (D), No building shall be erected upon any premises which is used for non-conforming purposes.

Law Director
Keith Michfeld

I feel the code is very specific and hope you understand my reason for denial. If you have any questions, please feel free to call.

Yours truly,

Richard G. Hayman
Building Commissioner

RGH:dd

1074007

CITY OF NAPOLEON
BUILDING INSPECTION DEPARTMENT
APPLICATION FOR BUILDING PERMIT
(please print or type)

The undersigned hereby makes application for construction, installation, or alteration work as herein specified, agreeing to do all such work in strict accordance with the City of Napoleon's adopted Building Codes.

Location of project Nogrefe Auto Parts Cost of project \$2,000
Owner's Name Nogrefe Auto Parts Address 31 RT. 424 East
Contractor Randy Kelley Telephone No. 592-4456
Address 1018 Dodd St.

Lot Information: (not required for siding job)

Lot No. _____ Subdivision _____
Zoning District _____ Lot Size _____ ft. x _____ ft. Area _____ sq. ft.
Setbacks: Front 80' Right Side _____ Left Side _____ Rear _____

Work Information:

Residential _____ Commercial X Industrial _____
New Construction X Addition _____ Remodel _____

Accessory Building on skids Siding wood
(Specific Type)

Brief Description of Work: build 12x16 building on skids.

Size: Length 12 ft Width 16 ft No. of Stories 1

Area: 1st Floor 192 sq. ft. Basement _____ sq. ft.
2nd Floor _____ sq. ft. Accessory Building _____ sq. ft.
3rd Floor _____ sq. ft. Other _____ sq. ft.

Additional Information: _____

APPLICATION FOR PERMIT SHALL BE ACCOMPANIED BY TWO COMPLETE SETS OF PLANS INCLUDING: ELEVATIONS, FLOOR PLANS, CROSS SECTIONS AND PLOT PLAN. IF ADDITION OR REMODELING, SHOW ALL EXISTING STRUCTURES AND THEIR SIZE AND LOCATION. ALL PLANS SHALL BE DRAWN TO SCALE.

Date 8-26-80 Applicants Signature Randy Kelley

PERMIT NO. _____ PERMIT FEE \$ _____

portable building Hoopra

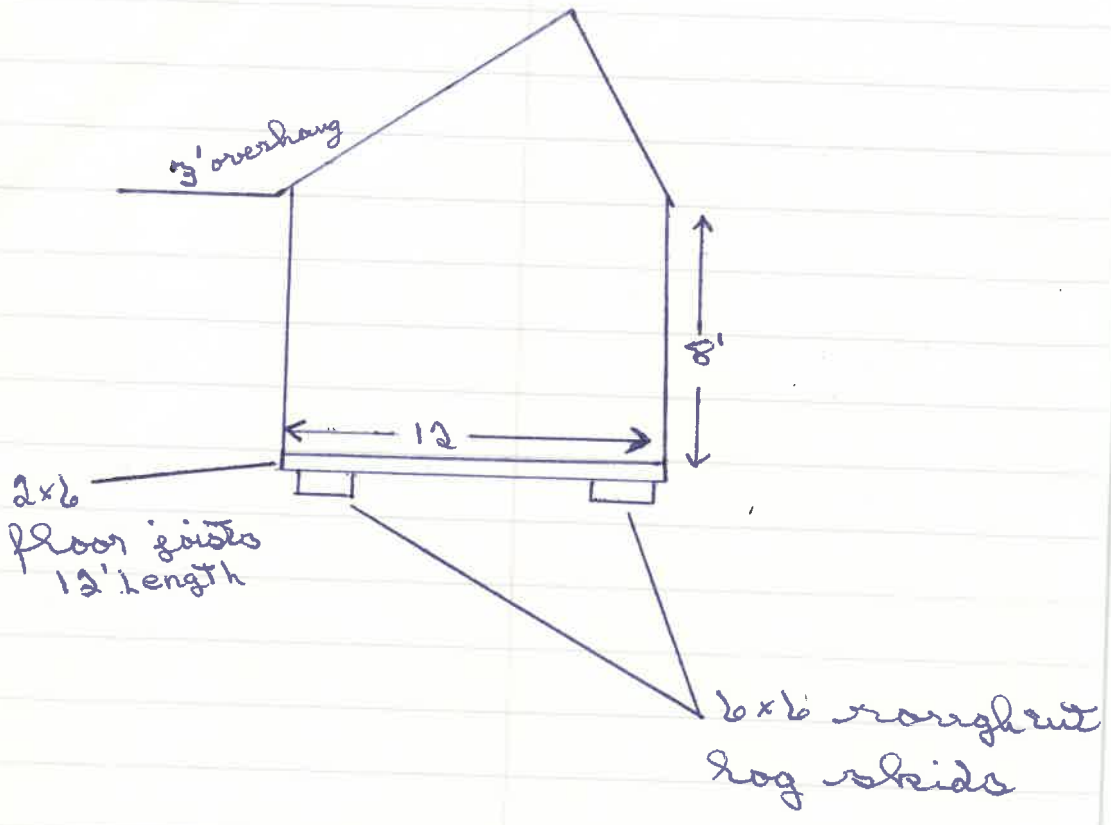

• Portable building Hoopfe

5 electric outlets

2 circuits - breakers

